

# TOWNSHIP 2 N., RANGE 6 W.W.M. TILLAMOOK CO. ORE.

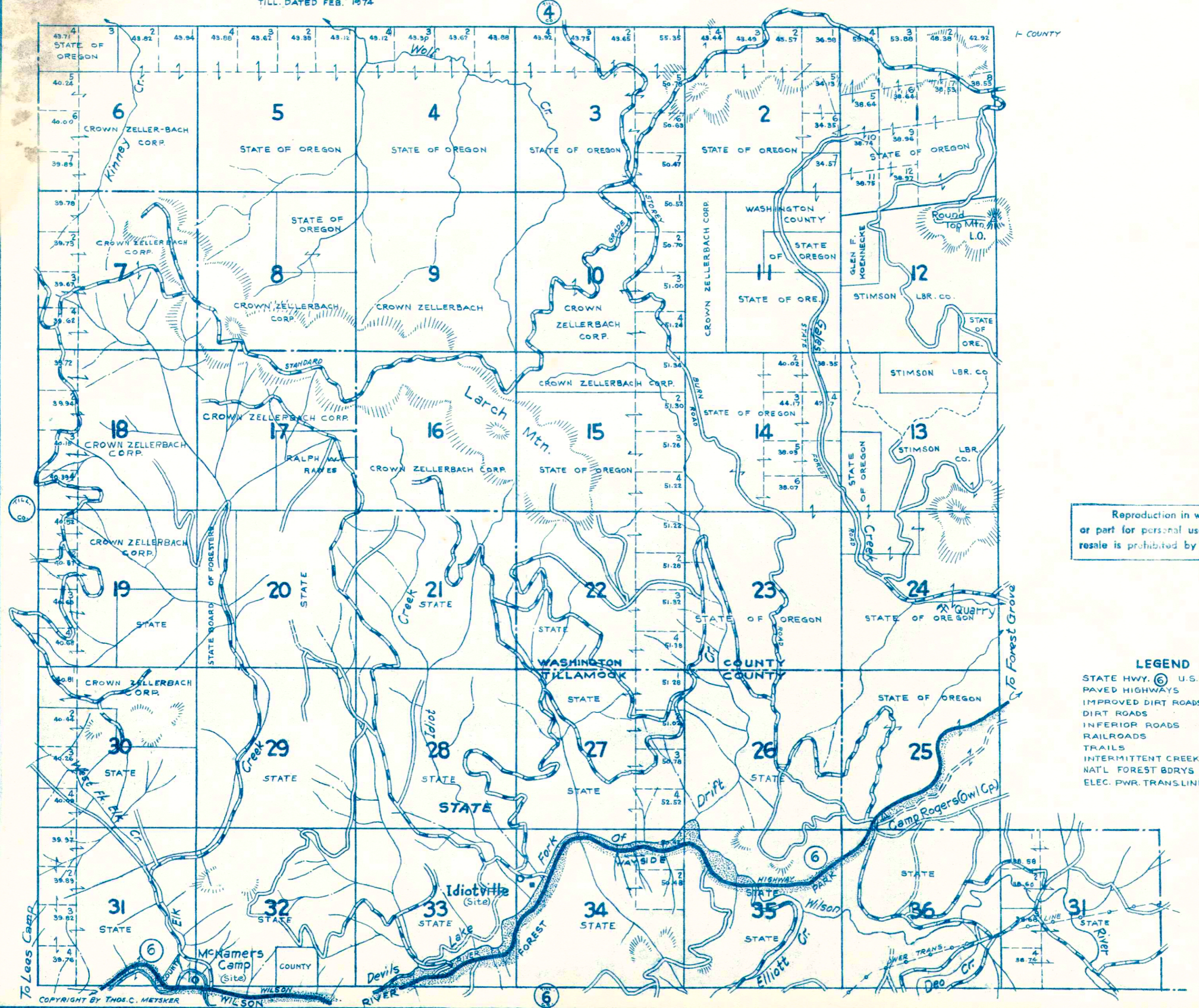

Reproduction in whole or part for personal use or resale is prohibited by law.

**LEGEND**

STATE HWY. 6	U.S. HWY. 101
PAVED HIGHWAYS	—————
IMPROVED DIRT ROADS	———
DIRT ROADS	———
INFERIOR ROADS	———
RAILROADS	———
TRAILS	———
INTERMITTENT CREEKS	~~~~~
NAT'L FOREST BDR'YS	XXXXXX
ELEC. PWR. TRANS. LINES	—o—o—